



C101 Series - Single Diameter Reamer

C101 Series (Cont.) - Single Diameter Reamer

APPLICATION

CNC, Robotic, and Hand reaming metals and composites

TOOL GEOMETRY
Straight multi flute

TOOL MATERIAL
Solid carbide

OD TOLERANCE
D1: +.0002"/-0"

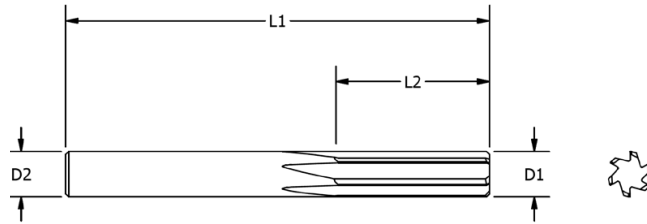

	Reamer Diameter (D1)		Overall Length	Flute Length	Shank Diameter	Number of Flutes	Part ID
	mm	inch	L1	L2	D2		
#40	2.489	0.0980	2.00	0.500	0.0980	4	C101-11254
#39	2.527	0.0995	2.25	0.625	0.0995	4	C101-11255
#38	2.578	0.1015	2.25	0.625	0.1015	4	C101-11256
#37	2.642	0.1040	2.25	0.625	0.1040	4	C101-11257
#36	2.705	0.1065	2.25	0.625	0.1065	4	C101-11258
7/64	2.779	0.1094	2.25	0.625	0.1094	4	C101-11259
#34	2.819	0.1110	2.25	0.625	0.1110	4	C101-11260
#33	2.870	0.1130	2.25	0.625	0.1130	4	C101-11261
#32	2.946	0.1160	2.25	0.625	0.1160	4	C101-11262
3mm	3.000	0.1181	2.25	0.625	0.1181	4	C101-11263
#31	3.048	0.1200	2.25	0.625	0.1200	4	C101-11264
1/8	3.175	0.1250	2.25	0.625	0.1250	4	C101-11265
#30	3.264	0.1285	2.25	0.625	0.1285	4	C101-11266
#29	3.454	0.1360	2.50	0.750	0.1360	4	C101-11267
9/64	3.571	0.1406	2.50	0.750	0.1406	4	C101-11268
#27	3.658	0.1440	2.50	0.750	0.1440	4	C101-11269
#26	3.734	0.1470	2.50	0.750	0.1470	4	C101-11270
#25	3.797	0.1495	2.50	0.750	0.1495	4	C101-11271
#24	3.861	0.1520	2.50	0.750	0.1520	4	C101-11272
#23	3.912	0.1540	2.50	0.750	0.1540	4	C101-11273
5/32	3.967	0.1562	2.50	0.750	0.1562	4	C101-11274
4mm	4.000	0.1575	2.50	0.750	0.1575	4	C101-11275
#21	4.039	0.1590	2.50	0.750	0.1590	4	C101-11276
#20	4.089	0.1610	2.50	0.750	0.1610	4	C101-11277
#19	4.216	0.1660	2.75	0.875	0.1660	4	C101-11278
#18	4.305	0.1695	2.75	0.875	0.1695	4	C101-11279
11/64	4.366	0.1719	2.75	0.875	0.1719	4	C101-11280
#17	4.394	0.1730	2.75	0.875	0.1730	4	C101-11281
#16	4.496	0.1770	2.75	0.875	0.1770	4	C101-11282
#15	4.572	0.1800	2.75	0.875	0.1800	4	C101-11283
#14	4.623	0.1820	2.75	0.875	0.1820	4	C101-11284
#13	4.699	0.1850	2.75	0.875	0.1850	4	C101-11285
3/16	4.763	0.1875	2.75	0.875	0.1875	4	C101-11286
#12	4.801	0.1890	2.75	0.875	0.1890	4	C101-11287
#11	4.851	0.1910	2.75	0.875	0.1910	4	C101-11288
#10	4.915	0.1935	2.75	0.875	0.1935	6	C101-11289

	Reamer Diameter (D1)		Overall Length	Flute Length	Shank Diameter	Number of Flutes	Part ID
	mm	inch	L1	L2	D2		
5mm	5.000	0.1969	3.00	1.000	0.1969	6	C101-11290
#8	5.055	0.1990	3.00	1.000	0.1990	6	C101-11291
#7	5.105	0.2010	3.00	1.000	0.2010	6	C101-11292
13/64	5.159	0.2031	3.00	1.000	0.2031	6	C101-11293
#6	5.182	0.2040	3.00	1.000	0.2040	6	C101-11294
#5	5.220	0.2055	3.00	1.000	0.2055	6	C101-11295
#4	5.309	0.2090	3.00	1.000	0.2090	6	C101-11296
#3	5.410	0.2130	3.00	1.000	0.2130	6	C101-11297
7/32	5.558	0.2188	3.00	1.000	0.2188	6	C101-11298
#2	5.613	0.2210	3.00	1.000	0.2210	6	C101-11299
#1	5.791	0.2280	3.00	1.000	0.2280	6	C101-11300
A	5.944	0.2340	3.00	1.000	0.2340	6	C101-11301
15/64	5.954	0.2344	3.00	1.000	0.2344	6	C101-11302
6mm	6.000	0.2362	3.00	1.000	0.2362	6	C101-11303
B	6.045	0.2380	3.00	1.000	0.2380	6	C101-11304
C	6.147	0.2420	3.00	1.000	0.2420	6	C101-11305
1/4	6.350	0.2500	3.00	1.000	0.2500	6	C101-11306
F	6.528	0.2570	3.25	1.125	0.2570	6	C101-11307
G	6.629	0.2610	3.25	1.125	0.2610	6	C101-11308
17/64	6.746	0.2656	3.25	1.125	0.2656	6	C101-11309
H	6.756	0.2660	3.25	1.125	0.2660	6	C101-11310
I	6.909	0.2720	3.25	1.125	0.2720	6	C101-11311
7mm	7.000	0.2756	3.25	1.125	0.2756	6	C101-11312
J	7.036	0.2770	3.25	1.125	0.2770	6	C101-11313
K	7.137	0.2810	3.25	1.125	0.2810	6	C101-11314
9/32	7.142	0.2812	3.25	1.125	0.2812	6	C101-11315
L	7.366	0.2900	3.25	1.125	0.2900	6	C101-11316
M	7.493	0.2950	3.25	1.125	0.2950	6	C101-11317
19/64	7.541	0.2969	3.25	1.125	0.2969	6	C101-11318
N	7.671	0.3020	3.25	1.125	0.3020	6	C101-11319
5/16	7.938	0.3125	3.25	1.125	0.3125	6	C101-11320
8mm	8.000	0.3150	3.50	1.250	0.3150	6	C101-11321
O	8.026	0.3160	3.50	1.250	0.3160	6	C101-11322
P	8.204	0.3230	3.50	1.250	0.3230	6	C101-11323
21/64	8.334	0.3281	3.50	1.250	0.3281	6	C101-11324
Q	8.433	0.3320	3.50	1.250	0.3320	6	C101-11325
R	8.611	0.3390	3.50	1.250	0.3390	6	C101-11326
11/32	8.733	0.3438	3.50	1.250	0.3438	6	C101-11327
S	8.839	0.3480	3.50	1.250	0.3480	6	C101-11328
9mm	9.000	0.3543	3.50	1.250	0.3543	6	C101-11329
T	9.093	0.3580	3.50	1.250	0.3580	6	C101-11331
23/64	9.129	0.3594	3.50	1.250	0.3594	6	C101-11332
U	9.347	0.3680	3.50	1.250	0.3680	6	C101-11333
3/8	9.525	0.3750	3.50	1.250	0.3750	6	C101-11334
V	9.576	0.3770	3.50	1.250	0.3770	6	C101-11335
W	9.804	0.3860	3.50	1.250	0.3860	6	C101-11336
25/64	9.921	0.3906	4.00	1.500	0.3906	6	C101-11337
10mm	10.000	0.3937	4.00	1.500	0.3937	6	C101-11338
X	10.084	0.3970	4.00	1.500	0.3970	6	C101-11339
Y	10.262	0.4040	4.00	1.500	0.4040	6	C101-11340
13/32	10.317	0.4062	4.00	1.500	0.4062	6	C101-11341
Z	10.490	0.4130	4.00	1.500	0.4130	6	C101-11343
27/64	10.716	0.4219	4.00	1.500	0.4219	6	C101-11344
11mm	11.000	0.4331	4.00	1.500	0.4331	6	C101-11345
7/16	11.113	0.4375	4.00	1.500	0.4375	6	C101-11346
29/64	11.509	0.4531	5.00	1.750	0.4531	6	C101-11347
15/32	11.908	0.4688	5.00	1.750	0.4688	6	C101-11348
12mm	12.000	0.4724	5.00	1.750	0.4724	6	C101-11349
31/64	12.304	0.4844	5.00	1.750	0.4844	6	C101-11350
1/2	12.700	0.5000	5.00	1.750	0.5000	6	C101-11351

C103 Series - Step Reamer

APPLICATION

CNC, Robotic, and Hand reaming metals, composites and metal/composite stacks

TOOL GEOMETRY

4 straight flutes with noncutting pilot

TOOL MATERIAL

Solid carbide

OD TOLERANCES

D1: $+0.002"/-0"$

D3: $\pm .001"$

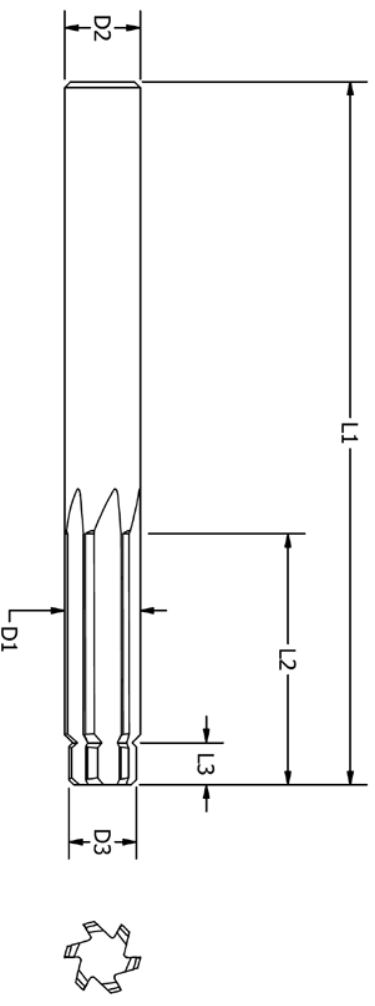

Reamer Diameter (D1)	Overall Length	Flute Length	Pilot Diameter	Pilot Dia Length	Shank Diameter	Number of Flutes	Part ID	
mm	inch	L1	L2	D3	L3	D2		
4.089	0.1610	5	2.00	0.1285	0.400	0.1610	4	C103-11868
4.763	0.1875	5	2.00	0.1610	0.400	0.1875	4	C103-11869
4.851	0.1910	5	2.00	0.1610	0.400	0.1910	4	C103-11870
5.537	0.2180	5	2.00	0.1910	0.400	0.2180	6	C103-11871
6.350	0.2500	5	2.00	0.2180	0.400	0.2500	6	C103-11872
7.137	0.2810	5	2.00	0.2500	0.400	0.2810	6	C103-11873
7.938	0.3125	5	2.00	0.2810	0.400	0.3125	6	C103-11874
8.738	0.3440	5	2.00	0.3125	0.400	0.3440	6	C103-11875
9.525	0.3750	5	2.00	0.3440	0.400	0.3750	6	C103-11876
10.287	0.4050	5	2.00	0.3750	0.400	0.4050	6	C103-11877
11.113	0.4375	6	3.00	0.4050	0.400	0.4375	6	C103-11878
11.887	0.4680	6	3.00	0.4375	0.400	0.4680	6	C103-11879
12.700	0.5000	6	3.00	0.4680	0.400	0.5000	6	C103-11880

REAMING TOOLS

C104 Series - Two Step Reamer

APPLICATION

CNC, Robotic, and Hand reaming metals, composites and metal/composite stacks

TOOL GEOMETRY

4 straight flutes with middle diameter and noncutting pilot

TOOL MATERIAL

Solid carbide

OD TOLERANCES

D1: $+ .0002" / - 0"$
 D3: $+ 0" / - .0005"$
 D4: $+ 0" / - .0005"$

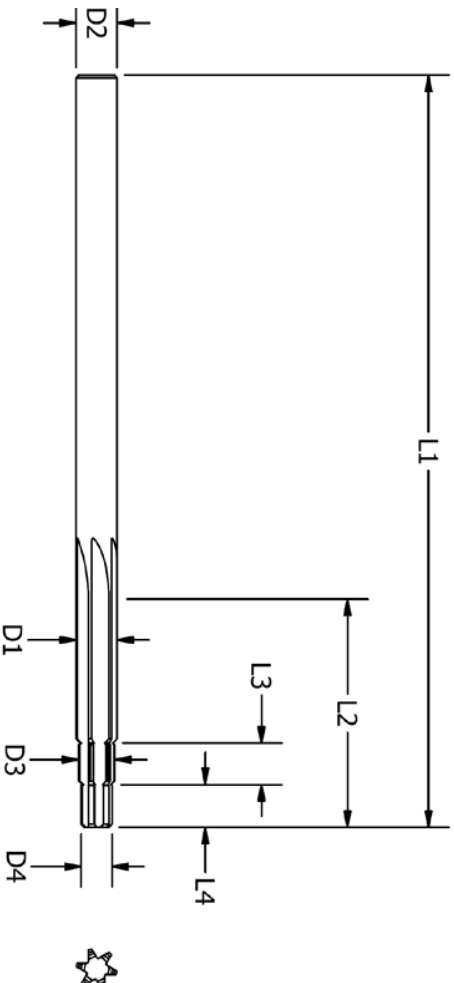

Reamer Diameter (D1)	Overall Length	Flute Length	Middle Diameter	Middle Dia Length	Pilot Diameter	Pilot Dia Length	Shank Diameter	Number of Flutes	Part ID	
mm	inch	L1	D3	L3	D4	L4	D2			
4.763	0.1875	5.00	1.85	0.1595	0.250	0.1285	0.400	0.1875	4	C104-11881
4.851	0.1910	5.00	1.85	0.1601	0.250	0.1285	0.400	0.1910	4	C104-11882
6.350	0.2500	5.00	1.85	0.2195	0.250	0.1895	0.400	0.2500	6	C104-11883
7.938	0.3125	5.00	1.85	0.2810	0.250	0.2500	0.400	0.3125	6	C104-11884
9.525	0.3750	5.00	1.85	0.3430	0.250	0.3120	0.400	0.3750	6	C104-11885
11.113	0.4375	6.00	2.00	0.4060	0.250	0.3750	0.400	0.4375	6	C104-11886
12.700	0.5000	6.00	2.00	0.4700	0.250	0.4375	0.400	0.5000	6	C104-11887

* Custom geometries and coatings available upon request.

C102 Series - Two Stage Reamer

APPLICATION

CNC, Robotic, and Hand reaming metals, composites and metal/composite stacks

TOOL GEOMETRY

4 straight flutes, two-stage transition angle and noncutting pilot

TOOL MATERIAL

Solid carbide

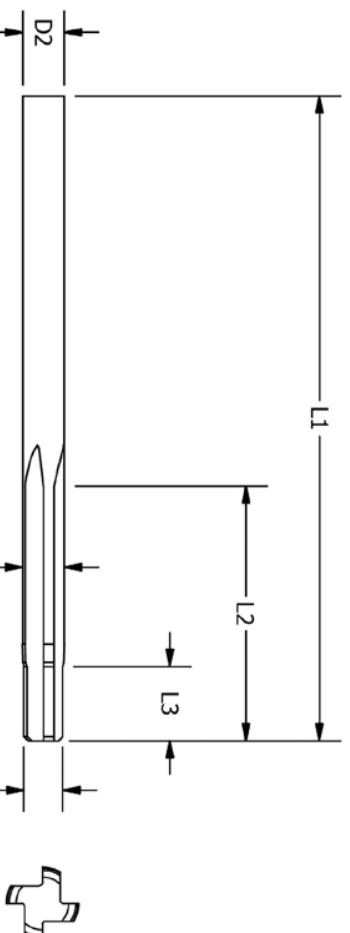

OD TOLERANCES

D1: +.0002"/-0"

D3: +0"/-.0005"

Reamer Diameter (D1)	Overall Length	Flute Length	Pilot Diameter	Pilot Dia Length	Shank Diameter	Number of Flutes	Part ID	
mm	inch	L1	L2	D3	L3	D2		
4.089	0.1610	5	2.00	0.1286	0.250	0.1610	4	C102-11928
4.763	0.1875	5	2.00	0.1610	0.250	0.1875	4	C102-11929
4.851	0.1910	5	2.00	0.1610	0.250	0.1910	4	C102-11930
5.537	0.2180	5	2.00	0.1910	0.250	0.2180	4	C102-11931
6.350	0.2500	5	2.00	0.2180	0.250	0.2500	4	C102-11932
7.137	0.2810	5	2.00	0.2500	0.250	0.2810	4	C102-11933
7.938	0.3125	5	2.00	0.2810	0.250	0.3125	4	C102-11934
8.738	0.3440	5	2.00	0.3125	0.250	0.3440	4	C102-11935
9.525	0.3750	5	2.00	0.3440	0.250	0.3750	4	C102-11936
10.287	0.4050	5	2.00	0.3750	0.250	0.4050	4	C102-11937
11.113	0.4375	6	3.00	0.4050	0.250	0.4375	4	C102-11938
11.887	0.4680	6	3.00	0.4375	0.250	0.4680	4	C102-11939
12.700	0.5000	6	3.00	0.4680	0.250	0.5000	4	C102-11940

REAMING TOOLS

C100 Series - Three Stage Reamer

APPLICATION
CNC, Robotic, and Hand reaming metals, composites and metal/composite stacks

TOOL GEOMETRY
4 straight flutes, two-stage transition angle, middle diameter and noncutting pilot

TOOL MATERIAL
Solid carbide

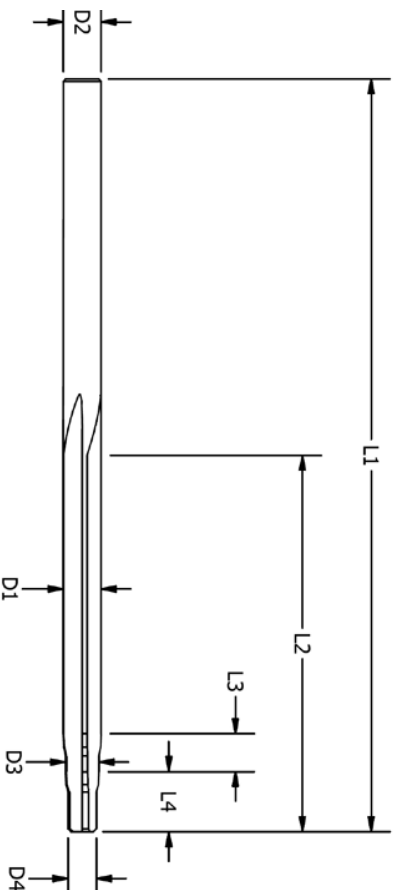

OD TOLERANCES
D1: +.0004" / +.0001"
D3: + 0" / -.001"
D4: + 0" / -.001"

Reamer Diameter (D1)	Overall Length	Flute Length	Middle Diameter	Middle Dia Length	Pilot Diameter	Pilot Dia Length	Shank Diameter	Number of Flutes	Part ID
mm	inch	L1	D3	L3	D4	L4	D2		
4.763	0.1875	5.00	0.1595	0.250	0.1285	0.400	0.1875	4	C100-06926
4.851	0.1910	5.00	0.1601	0.250	0.1285	0.400	0.1910	4	C100-11231
6.350	0.2500	5.00	0.2195	0.250	0.1895	0.400	0.2500	4	C100-11232
7.938	0.3125	5.00	0.2810	0.250	0.2500	0.400	0.3125	4	C100-11233
9.525	0.3750	5.00	0.3430	0.250	0.3120	0.400	0.3750	4	C100-11234
11.113	0.4375	6.00	0.4060	0.250	0.3750	0.400	0.4375	4	C100-08905
12.700	0.5000	6.00	0.4700	0.250	0.4375	0.400	0.5000	4	C100-08906

*Custom geometries and coatings available upon request.