



B100 Series - Helical Composite Drill Reamer diamond coated

APPLICATION

CNC, Robotic, and Hand drilling
carbon fiber (CFRP)

TOOL GEOMETRY

4 flute, reduced helix, RH cut,
12 facet point

TOOL MATERIAL

Solid carbide (CVD) diamond
coated

OD TOLERANCE

D1: +.0004" / -0.0002"

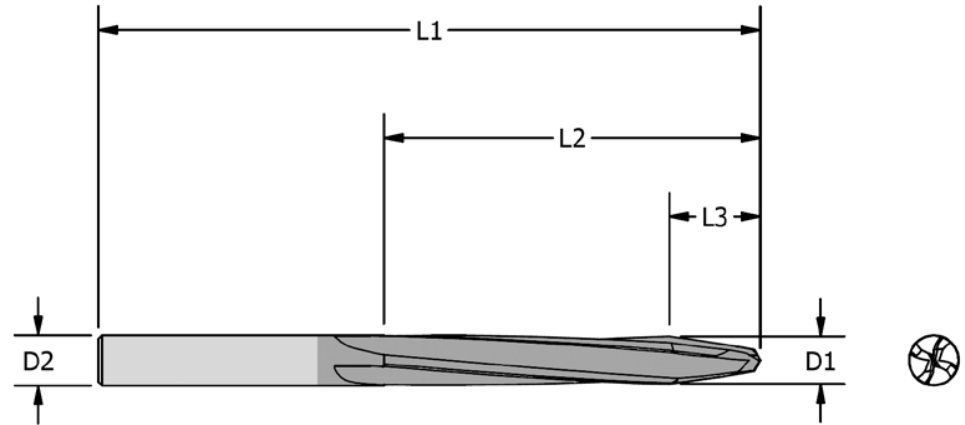

Drill Diameter (D1)		Overall Length	Flute Length	Taper Length	Shank Diameter	Diamond Coating	Part ID
mm	inch	L1	L2	L3	D2	Y/N	
2.489	0.0980	4	1.50	0.178	0.0980	Y	B100-10899
3.175	0.1250	4	1.50	0.228	0.1250	Y	B100-10900
3.264	0.1285	4	1.50	0.234	0.1285	Y	B100-10901
3.264	0.1285	6	1.50	0.234	0.1285	Y	B100-11144
4.102	0.1615	4	1.50	0.294	0.1615	Y	B100-11163
4.102	0.1615	6	1.50	0.294	0.1615	Y	B100-11164
4.166	0.1640	4	1.50	0.298	0.1640	Y	B100-10903
4.166	0.1640	6	1.50	0.298	0.1640	Y	B100-11145
4.763	0.1875	4	1.50	0.341	0.1875	Y	B100-10904
4.763	0.1875	6	1.50	0.341	0.1875	Y	B100-11146
4.826	0.1900	4	1.50	0.346	0.1900	Y	B100-10905
4.826	0.1900	6	1.50	0.346	0.1900	Y	B100-11147
4.851	0.1910	4	1.50	0.348	0.1910	Y	B100-10902
4.851	0.1910	6	1.50	0.348	0.1910	Y	B100-11148
4.915	0.1935	4	1.50	0.352	0.1935	Y	B100-13660
4.915	0.1935	6	1.50	0.352	0.1935	Y	B100-13661
6.350	0.2500	4	1.50	0.455	0.2500	Y	B100-04870
6.350	0.2500	6	1.50	0.455	0.2500	Y	B100-11149
6.375	0.2510	4	1.50	0.457	0.2510	Y	B100-10906
6.375	0.2510	6	1.50	0.457	0.2510	Y	B100-11150
7.938	0.3125	4	1.50	0.569	0.3125	Y	B100-10907
7.938	0.3125	6	1.50	0.569	0.3125	Y	B100-11151
7.950	0.3130	4	1.50	0.570	0.3130	Y	B100-10908
7.950	0.3130	6	1.50	0.570	0.3130	Y	B100-11152
9.525	0.3750	4	2.00	0.683	0.3750	Y	B100-10909
9.525	0.3750	6	2.00	0.683	0.3750	Y	B100-11158
9.538	0.3755	4	2.00	0.683	0.3755	Y	B100-10910
9.538	0.3755	6	2.00	0.683	0.3755	Y	B100-11159
11.113	0.4375	6	3.00	0.796	0.4375	Y	B100-11161
12.700	0.5000	6	3.00	0.910	0.5000	Y	B100-11162

COMPOSITE DRILLING

B800 Series - Helical Composite Drill Reamer w/ Common Shank diamond coated

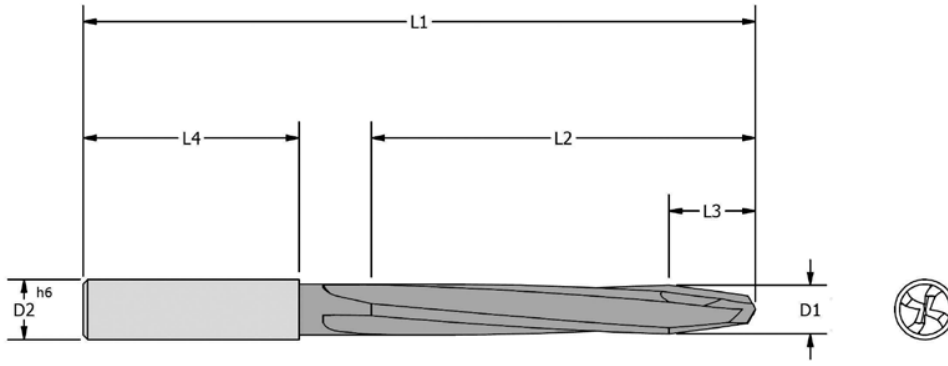

APPLICATION

CNC, Robotic, and Hand drilling carbon fiber (CFRP)

TOOL GEOMETRY

4 flute, reduced helix, RH cut, 12 facet point

TOOL MATERIAL

Solid carbide (CVD) diamond coated

OD TOLERANCE

D1: +.0004" / -.0002"

Drill Diameter (D1)		Overall Length	Flute Length	Taper Length	Shank Diameter	Diamond Coating	Part ID
mm	inch	L1	L2	L3	D2 (h6)	Y/N	
6.363	0.2505	4	1.50	0.456	0.2500	Y	B800-13448
6.363	0.2505	6	1.50	0.456	0.2500	Y	B800-13450
6.375	0.2510	4	1.50	0.457	0.2500	Y	B800-13452
6.375	0.2510	6	1.50	0.457	0.2500	Y	B800-13454
6.388	0.2515	4	1.50	0.458	0.2500	Y	B800-13456
6.388	0.2515	6	1.50	0.458	0.2500	Y	B800-13458
6.401	0.2520	4	1.50	0.459	0.2500	Y	B800-13460
6.401	0.2520	6	1.50	0.459	0.2500	Y	B800-13462
7.938	0.3125	4	1.50	0.569	0.3750	Y	B800-13464
7.938	0.3125	6	1.50	0.569	0.3750	Y	B800-13466
7.950	0.3130	4	1.50	0.570	0.3750	Y	B800-13468
7.950	0.3130	6	1.50	0.570	0.3750	Y	B800-13470
9.525	0.3750	4	2.00	0.683	0.3750	Y	B800-13589
9.525	0.3750	6	2.00	0.683	0.3750	Y	B800-13472
9.538	0.3755	4	2.00	0.683	0.3750	Y	B800-13474
9.538	0.3755	6	2.00	0.683	0.3750	Y	B800-13476
11.113	0.4375	6	3.00	0.796	0.5000	Y	B800-13478

*Custom geometries available upon request

B100 Series - Helical Composite Drill Reamer uncoated

APPLICATION

CNC, Robotic, and Hand drilling
carbon fiber (CFRP)

TOOL GEOMETRY

4 flute, reduced helix, RH cut,
12 facet point

TOOL MATERIAL

Solid carbide

OD TOLERANCE

D1: $+0.0002"/-0"$

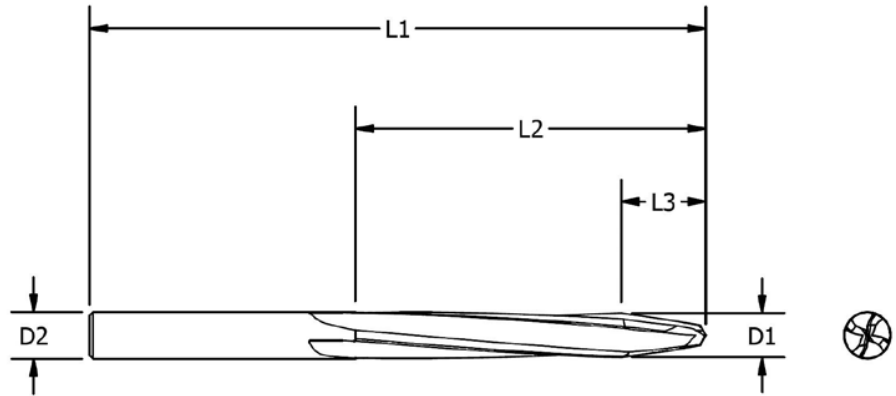

Drill Diameter (D1)		Overall Length	Flute Length	Taper Length	Shank Diameter	Diamond Coating	Part ID
mm	inch	L1	L2	L3	D2	Y/N	
2.489	0.0980	4	1.50	0.178	0.0980	N	B100-10887
3.175	0.1250	4	1.50	0.228	0.1250	N	B100-10888
3.264	0.1285	4	1.50	0.234	0.1285	N	B100-10889
3.264	0.1285	6	1.50	0.234	0.1285	N	B100-10991
4.102	0.1615	4	1.50	0.294	0.1615	N	B100-11166
4.102	0.1615	6	1.50	0.294	0.1615	N	B100-11167
4.166	0.1640	4	1.50	0.298	0.1640	N	B100-10890
4.166	0.1640	6	1.50	0.298	0.1640	N	B100-11165
4.763	0.1875	4	1.50	0.341	0.1875	N	B100-10891
4.763	0.1875	6	1.50	0.341	0.1875	N	B100-10993
4.826	0.1900	4	1.50	0.346	0.1900	N	B100-10892
4.826	0.1900	6	1.50	0.346	0.1900	N	B100-10995
4.851	0.1910	4	1.50	0.348	0.1910	N	B100-10893
4.851	0.1910	6	1.50	0.348	0.1910	N	B100-10996
4.915	0.1935	4	1.50	0.352	0.1935	N	B100-13660
4.915	0.1935	6	1.50	0.352	0.1935	N	B100-13661
6.350	0.2500	4	1.50	0.455	0.2500	N	B100-06725
6.350	0.2500	6	1.50	0.455	0.2500	N	B100-07023
6.375	0.2510	4	1.50	0.457	0.2510	N	B100-10894
6.375	0.2510	6	1.50	0.457	0.2510	N	B100-10997
7.938	0.3125	4	1.50	0.569	0.3125	N	B100-10895
7.938	0.3125	6	1.50	0.569	0.3125	N	B100-10998
7.950	0.3130	4	1.50	0.570	0.3130	N	B100-10896
7.950	0.3130	6	1.50	0.570	0.3130	N	B100-10999
9.525	0.3750	4	2.00	0.683	0.3750	N	B100-07994
9.525	0.3750	6	2.00	0.683	0.3750	N	B100-11000
9.538	0.3755	4	2.00	0.683	0.3755	N	B100-10898
9.538	0.3755	6	2.00	0.683	0.3755	N	B100-11001
11.113	0.4375	6	3.00	0.796	0.4375	N	B100-11002
12.700	0.5000	6	3.00	0.910	0.5000	N	B100-11003

COMPOSITE DRILLING

B800 Series - Helical Composite Drill Reamer w/ Common Shank uncoated

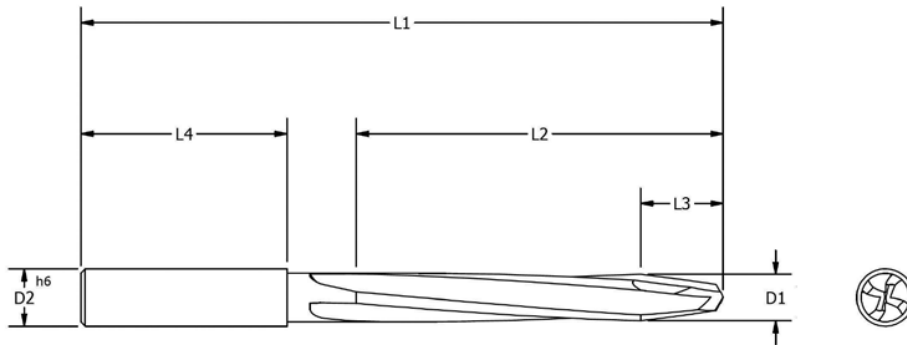

APPLICATION

CNC, Robotic, and Hand drilling carbon fiber (CFRP)

TOOL GEOMETRY

4 flute, reduced helix, RH cut, 12 facet point

TOOL MATERIAL

Solid carbide

OD TOLERANCE

D1: $+.0002'' / -0''$

Drill Diameter (D1)		Overall Length	Flute Length	Taper Length	Shank Diameter	Diamond Coating	Part ID
mm	inch	L1	L2	L3	D2 (h6)	Y/N	
6.363	0.2505	4	1.50	0.456	0.2500	N	B800-13447
6.363	0.2505	6	1.50	0.456	0.2500	N	B800-13449
6.375	0.2510	4	1.50	0.457	0.2500	N	B800-13451
6.375	0.2510	6	1.50	0.457	0.2500	N	B800-13453
6.388	0.2515	4	1.50	0.458	0.2500	N	B800-13455
6.388	0.2515	6	1.50	0.458	0.2500	N	B800-13457
6.401	0.2520	4	1.50	0.459	0.2500	N	B800-13459
6.401	0.2520	6	1.50	0.459	0.2500	N	B800-13461
7.938	0.3125	4	1.50	0.569	0.3750	N	B800-13463
7.938	0.3125	6	1.50	0.569	0.3750	N	B800-13465
7.950	0.3130	4	1.50	0.570	0.3750	N	B800-13467
7.950	0.3130	6	1.50	0.570	0.3750	N	B800-13469
9.525	0.3750	4	2.00	0.683	0.3750	N	B800-13471
9.538	0.3755	4	2.00	0.683	0.3750	N	B800-13473
9.538	0.3755	6	2.00	0.683	0.3750	N	B800-13475
11.113	0.4375	6	3.00	0.796	0.5000	N	B800-13477

*Custom geometries and coatings available upon request.

B103 Series - Straight Flute Composite Drill Reamer diamond coated

APPLICATION

CNC, Robotic, and Hand drilling
carbon fiber (CFRP)

TOOL GEOMETRY

4 flute, straight flutes, RH cut,
12 facet point

TOOL MATERIAL

Solid carbide (CVD) diamond
coated

OD TOLERANCE

D1: $+0.0004'' / -0.0002''$

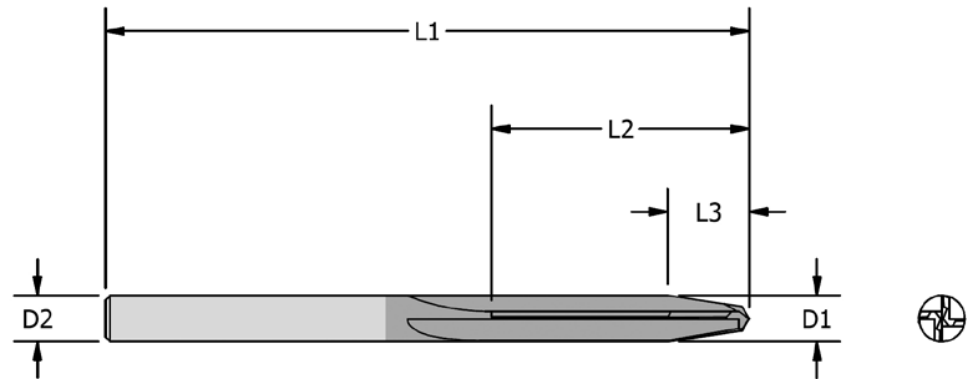

Drill Diameter (D1)		Overall Length	Flute Length	Taper Length	Shank Diameter	Diamond Coating	Part ID
mm	inch	L1	L2	L3	D2	Y/N	
2.489	0.0980	4	1.50	0.178	0.0980	Y	B103-11583
3.175	0.1250	4	1.50	0.228	0.1250	Y	B103-11584
3.264	0.1285	4	1.50	0.234	0.1285	Y	B103-11585
3.264	0.1285	6	1.50	0.234	0.1285	Y	B103-11586
4.102	0.1615	4	1.50	0.294	0.1615	Y	B103-11587
4.102	0.1615	6	1.50	0.294	0.1615	Y	B103-11588
4.166	0.1640	4	1.50	0.298	0.1640	Y	B103-11589
4.166	0.1640	6	1.50	0.298	0.1640	Y	B103-11590
4.763	0.1875	4	1.50	0.341	0.1875	Y	B103-11591
4.763	0.1875	6	1.50	0.341	0.1875	Y	B103-11592
4.826	0.1900	4	1.50	0.346	0.1900	Y	B103-11593
4.826	0.1900	6	1.50	0.346	0.1900	Y	B103-11594
4.851	0.1910	4	1.50	0.348	0.1910	Y	B103-11595
4.851	0.1910	6	1.50	0.348	0.1910	Y	B103-11596
4.915	0.1935	4	1.50	0.352	0.1935	Y	B103-13662
4.915	0.1935	6	1.50	0.352	0.1935	Y	B103-13663
6.350	0.2500	4	1.50	0.455	0.2500	Y	B103-11597
6.350	0.2500	6	1.50	0.455	0.2500	Y	B103-11598
6.375	0.2510	4	1.50	0.457	0.2510	Y	B103-11599
6.375	0.2510	6	1.50	0.457	0.2510	Y	B103-11600
7.938	0.3125	4	1.50	0.569	0.3125	Y	B103-11601
7.938	0.3125	6	1.50	0.569	0.3125	Y	B103-11602
7.950	0.3130	4	1.50	0.570	0.3130	Y	B103-11603
7.950	0.3130	6	1.50	0.570	0.3130	Y	B103-11604
9.525	0.3750	4	2.00	0.683	0.3750	Y	B103-11605
9.525	0.3750	6	2.00	0.683	0.3750	Y	B103-11606
9.538	0.3755	4	2.00	0.683	0.3755	Y	B103-11607
9.538	0.3755	6	2.00	0.683	0.3755	Y	B103-11608
11.113	0.4375	6	2.50	0.796	0.4375	Y	B103-11609
12.700	0.5000	6	2.50	0.910	0.5000	Y	B103-11610

COMPOSITE DRILLING

B803 Series - Straight Flute Composite Drill Reamer w/ Common Shank diamond coated

APPLICATION

CNC, Robotic, and Hand drilling
carbon fiber (CFRP)

TOOL GEOMETRY

4 flute, straight flutes, RH cut,
12 facet point

TOOL MATERIAL

Solid carbide (CVD) diamond
coated

OD TOLERANCE

D1: $+0.0004" / -0.0002"$

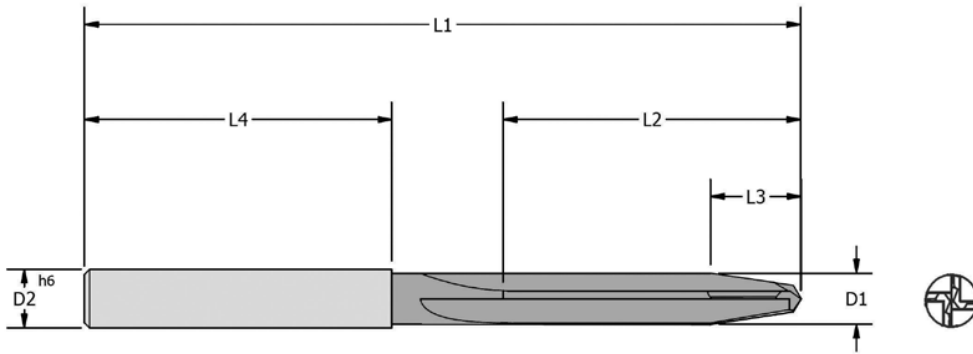

Drill Diameter (D1)		Overall Length	Flute Length	Taper Length	Shank Diameter	Diamond Coating	Part ID
mm	inch	L1	L2	L3	D2	Y/N	
2.489	0.0980	4	1.50	0.178	0.2500	Y	B803-13563
3.175	0.1250	4	1.50	0.228	0.2500	Y	B803-13564
3.264	0.1285	4	1.50	0.234	0.2500	Y	B803-13565
3.264	0.1285	6	1.50	0.234	0.2500	Y	B803-13566
4.102	0.1615	4	1.50	0.294	0.2500	Y	B803-13567
4.102	0.1615	6	1.50	0.294	0.2500	Y	B803-13568
4.166	0.1640	4	1.50	0.298	0.2500	Y	B803-13569
4.166	0.1640	6	1.50	0.298	0.2500	Y	B803-13570
4.763	0.1875	4	1.50	0.341	0.2500	Y	B803-13571
4.826	0.1900	4	1.50	0.346	0.2500	Y	B803-13573
4.826	0.1900	6	1.50	0.346	0.2500	Y	B803-13574
4.839	0.1905	4	1.50	0.347	0.2500	Y	B803-13528
4.839	0.1905	6	1.50	0.347	0.2500	Y	B803-13530
4.851	0.1910	4	1.50	0.348	0.2500	Y	B803-13575
4.851	0.1910	6	1.50	0.348	0.2500	Y	B803-13576
4.864	0.1915	4	1.50	0.349	0.2500	Y	B803-13534
4.864	0.1915	6	1.50	0.349	0.2500	Y	B803-13536
4.877	0.1920	4	1.50	0.349	0.2500	Y	B803-13538
4.877	0.1920	6	1.50	0.349	0.2500	Y	B803-13540
6.363	0.2505	4	1.50	0.456	0.2500	Y	B803-13542
6.363	0.2505	6	1.50	0.456	0.2500	Y	B803-13544
6.375	0.2510	4	1.50	0.457	0.2500	Y	B803-13577
6.375	0.2510	6	1.50	0.457	0.2500	Y	B803-13578
6.388	0.2515	4	1.50	0.458	0.2500	Y	B803-13548
6.388	0.2515	6	1.50	0.458	0.2500	Y	B803-13550
6.401	0.2520	4	1.50	0.459	0.2500	Y	B803-13552
6.401	0.2520	6	1.50	0.459	0.2500	Y	B803-13554
7.938	0.3125	4	1.50	0.569	0.3750	Y	B803-13579
7.938	0.3125	6	1.50	0.569	0.3750	Y	B803-13580
7.950	0.3130	4	1.50	0.570	0.3750	Y	B803-13581
7.950	0.3130	6	1.50	0.570	0.3750	Y	B803-13582
9.525	0.3750	4	2.00	0.683	0.3750	Y	B803-13583
9.525	0.3750	6	2.00	0.683	0.3750	Y	B803-13584
9.538	0.3755	4	2.00	0.683	0.3750	Y	B803-13585
9.538	0.3755	6	2.00	0.683	0.3750	Y	B803-13586
11.113	0.4375	6	2.50	0.796	0.5000	Y	B803-13587

*Custom geometries and coatings available upon request.



B103 Series - Straight Flute Composite Drill Reamer uncoated

APPLICATION

CNC, Robotic, and Hand drilling
carbon fiber (CFRP)

TOOL GEOMETRY

4 straight flutes, RH cut,
12 facet point

TOOL MATERIAL

Solid carbide

OD TOLERANCE

D1: $+0.0002'' / -0.0''$

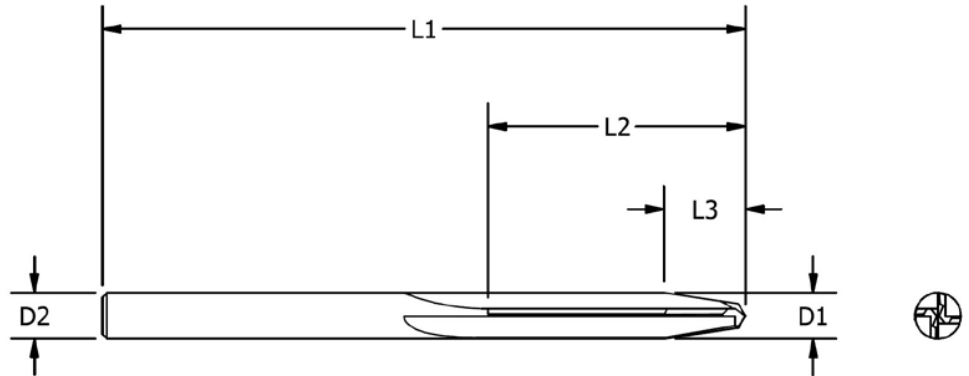

Drill Diameter (D1)		Overall Length	Flute Length	Taper Length	Shank Diameter	Diamond Coating	Part ID
mm	inch	L1	L2	L3	D2	Y/N	
2.489	0.0980	4	1.50	0.178	0.0980	N	B103-11004
3.175	0.1250	4	1.50	0.228	0.1250	N	B103-11005
3.264	0.1285	4	1.50	0.234	0.1285	N	B103-11006
3.264	0.1285	6	1.50	0.234	0.1285	N	B103-11007
4.102	0.1615	4	1.50	0.294	0.1615	N	B103-11008
4.102	0.1615	6	1.50	0.294	0.1615	N	B103-11009
4.166	0.1640	4	1.50	0.298	0.1640	N	B103-11010
4.166	0.1640	6	1.50	0.298	0.1640	N	B103-11011
4.763	0.1875	4	1.50	0.341	0.1875	N	B103-07389
4.763	0.1875	6	1.50	0.341	0.1875	N	B103-11012
4.826	0.1900	4	1.50	0.346	0.1900	N	B103-11013
4.826	0.1900	6	1.50	0.346	0.1900	N	B103-11014
4.851	0.1910	4	1.50	0.348	0.1910	N	B103-11015
4.851	0.1910	6	1.50	0.348	0.1910	N	B103-11017
4.915	0.1935	4	1.50	0.352	0.1935	N	B103-13662
4.915	0.1935	6	1.50	0.352	0.1935	N	B103-13663
6.350	0.2500	4	1.50	0.455	0.2500	N	B103-05845
6.350	0.2500	6	1.50	0.455	0.2500	N	B103-11018
6.375	0.2510	4	1.50	0.457	0.2510	N	B103-08729
6.375	0.2510	6	1.50	0.457	0.2510	N	B103-11019
7.938	0.3125	4	1.50	0.569	0.3125	N	B103-11020
7.938	0.3125	6	1.50	0.569	0.3125	N	B103-11021
7.950	0.3130	4	1.50	0.570	0.3130	N	B103-11022
7.950	0.3130	6	1.50	0.570	0.3130	N	B103-11023
9.525	0.3750	4	2.00	0.683	0.3750	N	B103-07395
9.525	0.3750	6	2.00	0.683	0.3750	N	B103-11024
9.538	0.3755	4	2.00	0.683	0.3755	N	B103-11025
9.538	0.3755	6	2.00	0.683	0.3755	N	B103-11026
11.113	0.4375	6	2.50	0.796	0.4375	N	B103-11027
12.700	0.5000	6	2.50	0.910	0.5000	N	B103-11028

COMPOSITE DRILLING

B803 Series - Straight Flute Composite Drill Reamer w/ Common Shank uncoated

APPLICATION

CNC, Robotic, and Hand drilling
carbon fiber (CFRP)

TOOL GEOMETRY

4 straight flutes, RH cut, 12
facet point

TOOL MATERIAL

Solid carbide

OD TOLERANCE

D1: +.0002" / -0"

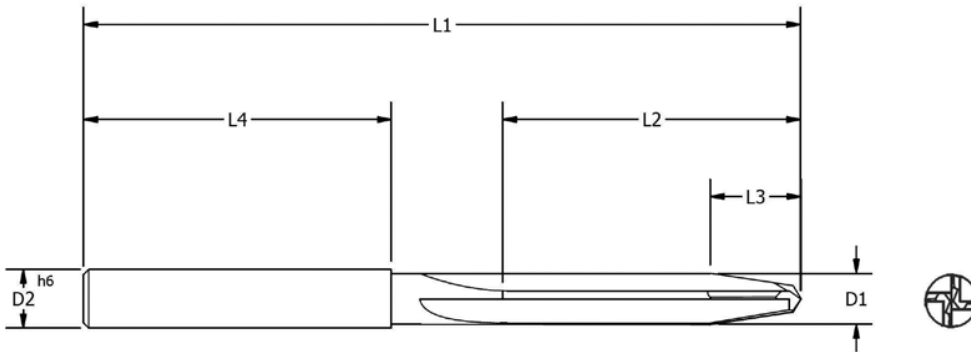

Drill Diameter (D1)		Overall Length	Flute Length	Taper Length	Shank Diameter	Diamond Coating	Part ID
mm	inch	L1	L2	L3	D2 (h6)	Y/N	
2.489	0.0980	4	1.50	0.178	0.2500	N	B803-13515
3.175	0.1250	4	1.50	0.228	0.2500	N	B803-13516
3.264	0.1285	4	1.50	0.234	0.2500	N	B803-13517
3.264	0.1285	6	1.50	0.234	0.2500	N	B803-13518
4.102	0.1615	4	1.50	0.294	0.2500	N	B803-13519
4.102	0.1615	6	1.50	0.294	0.2500	N	B803-13520
4.166	0.1640	4	1.50	0.298	0.2500	N	B803-13521
4.166	0.1640	6	1.50	0.298	0.2500	N	B803-13522
4.763	0.1875	4	1.50	0.341	0.2500	N	B803-13523
4.763	0.1875	6	1.50	0.341	0.2500	N	B803-13524
4.826	0.1900	4	1.50	0.346	0.2500	N	B803-13525
4.826	0.1900	6	1.50	0.346	0.2500	N	B803-13526
4.839	0.1905	4	1.50	0.347	0.2500	N	B803-13527
4.839	0.1905	6	1.50	0.347	0.2500	N	B803-13529
4.851	0.1910	4	1.50	0.348	0.2500	N	B803-13531
4.851	0.1910	6	1.50	0.348	0.2500	N	B803-13532
4.864	0.1915	4	1.50	0.349	0.2500	N	B803-13533
4.864	0.1915	6	1.50	0.349	0.2500	N	B803-13535
4.877	0.1920	4	1.50	0.349	0.2500	N	B803-13537
4.877	0.1920	6	1.50	0.349	0.2500	N	B803-13539
6.363	0.2505	4	1.50	0.456	0.2500	N	B803-13541
6.363	0.2505	6	1.50	0.456	0.2500	N	B803-13543
6.375	0.2510	4	1.50	0.457	0.2500	N	B803-13545
6.375	0.2510	6	1.50	0.457	0.2500	N	B803-13546
6.388	0.2515	4	1.50	0.458	0.2500	N	B803-13547
6.388	0.2515	6	1.50	0.458	0.2500	N	B803-13549
6.401	0.2520	4	1.50	0.459	0.2500	N	B803-13551
6.401	0.2520	6	1.50	0.459	0.2500	N	B803-13553
7.938	0.3125	4	1.50	0.569	0.3750	N	B803-13555
7.938	0.3125	6	1.50	0.569	0.3750	N	B803-13556
7.950	0.3130	4	1.50	0.570	0.3750	N	B803-13557
7.950	0.3130	6	1.50	0.570	0.3750	N	B803-13558
9.525	0.3750	6	2.00	0.683	0.3750	N	B803-13559
9.538	0.3755	4	2.00	0.683	0.3750	N	B803-13560
9.538	0.3755	6	2.00	0.683	0.3750	N	B803-13561
11.113	0.4375	6	2.00	0.796	0.5000	N	B803-13562

*Custom geometries available upon request.

B101 Series - Helical Composite Drill Reamer Short Taper diamond coated

APPLICATION

CNC, Robotic, and Hand drilling
carbon fiber (CFRP)

TOOL GEOMETRY

4 flutes, reduced helix, reduced
taper, RH cut, 12 facet point

TOOL MATERIAL

Solid carbide (CVD) diamond
coated

OD TOLERANCE

D1: +.0004" / -.0002"

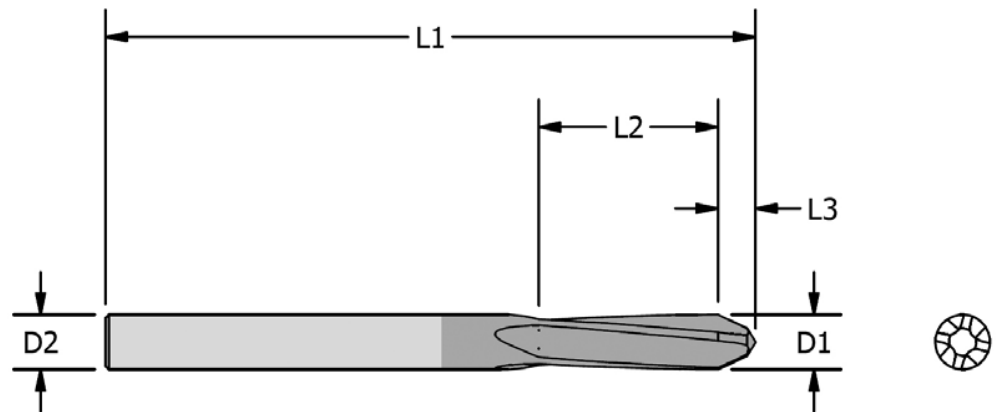

Drill Diameter (D1)		Overall Length	Flute Length	Taper Length	Shank Diameter	Diamond Coating	Part ID
mm	inch	L1	L2	L3	D2	Y/N	
2.489	0.0980	3	1.00	0.067	0.0980	Y	B101-10943
3.175	0.1250	3	1.00	0.068	0.1250	Y	B101-10944
3.264	0.1285	3	1.00	0.088	0.1285	Y	B101-10945
4.102	0.1615	3	1.25	0.111	0.1615	Y	B101-11106
4.166	0.1640	3	1.25	0.113	0.1640	Y	B101-08870
4.763	0.1875	3	1.25	0.129	0.1875	Y	B101-10946
4.826	0.1900	3	1.25	0.130	0.1900	Y	B101-11107
4.851	0.1910	3	1.25	0.131	0.1910	Y	B101-08871
4.915	0.1935	3	1.25	0.131	0.1935	Y	B101-13664
6.350	0.2500	3	1.25	0.172	0.2500	Y	B101-10516
6.375	0.2510	3	1.25	0.172	0.2510	Y	B101-10947
7.938	0.3125	4	1.50	0.214	0.3125	Y	B101-10948
7.950	0.3130	4	1.50	0.215	0.3130	Y	B101-11108
9.525	0.3750	4	1.50	0.257	0.3750	Y	B101-10949
11.113	0.4375	4	1.50	0.300	0.4375	Y	B101-11109
12.700	0.5000	4	1.50	0.343	0.5000	Y	B101-11110

COMPOSITE DRILLING

B801 Series - Helical Composite Drill Reamer Short Taper w/ Common Shank diamond coated

APPLICATION

CNC, Robotic, and Hand drilling carbon fiber (CFRP)

TOOL GEOMETRY

4 flutes, reduced helix, reduced taper, RH cut, 12 facet point

TOOL MATERIAL

Solid carbide (CVD) diamond coated

OD TOLERANCE

D1: +.0004" / -.0002"

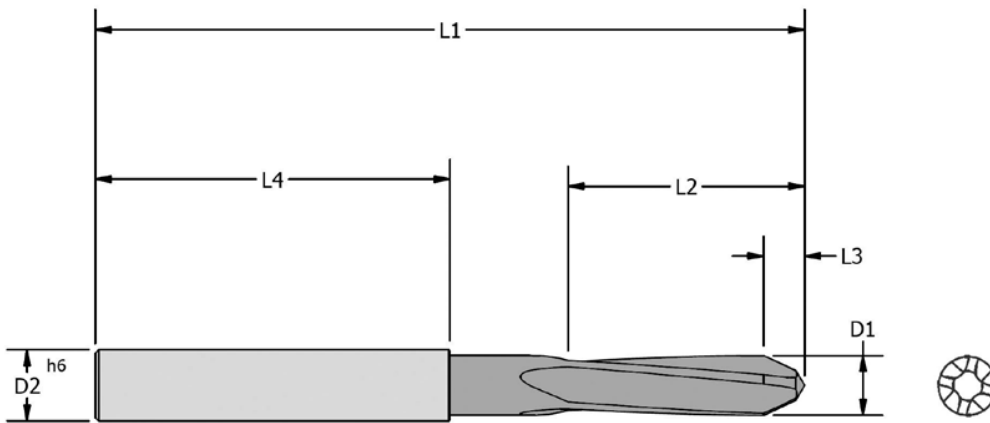

Drill Diameter (D1)		Overall Length	Flute Length	Taper Length	Shank Diameter	Diamond Coating	Part ID
mm	inch	L1	L2	L3	D2	Y/N	
2.489	0.0980	3	1.00	0.178	0.2500	Y	B801-13480
3.175	0.1250	3	1.00	0.228	0.2500	Y	B801-13482
3.264	0.1285	3	1.00	0.234	0.2500	Y	B801-13484
4.102	0.1615	3	1.25	0.294	0.2500	Y	B801-13486
4.166	0.1640	3	1.25	0.298	0.2500	Y	B801-13488
4.763	0.1875	3	1.25	0.341	0.2500	Y	B801-13490
4.826	0.1900	3	1.25	0.346	0.2500	Y	B801-13492
4.839	0.1905	3	1.25	0.347	0.2500	Y	B801-13494
4.851	0.1910	3	1.25	0.348	0.2500	Y	B801-13496
4.864	0.1915	3	1.25	0.349	0.2500	Y	B801-13498
4.877	0.1920	3	1.25	0.349	0.2500	Y	B801-13500
6.363	0.2505	3	1.25	0.456	0.2500	Y	B801-13502
6.375	0.2510	3	1.25	0.457	0.2500	Y	B801-13504
6.388	0.2515	3	1.25	0.458	0.2500	Y	B801-13506
6.401	0.2520	3	1.25	0.459	0.2500	Y	B801-13508
7.938	0.3125	4	1.50	0.569	0.3750	Y	B801-13510
7.950	0.3130	4	1.50	0.570	0.3750	Y	B801-13512
11.113	0.4375	4	1.50	0.796	0.5000	Y	B801-13514

*Custom geometries and coatings available upon request.

B101 Series - Helical Composite Drill Reamer Short Taper uncoated

APPLICATION

CNC, Robotic, and Hand drilling
carbon fiber (CFRP)

TOOL GEOMETRY

4 flutes, reduced helix, reduced
taper, RH cut, 12 facet point

TOOL MATERIAL

Solid carbide

OD TOLERANCE

D1: +.0002" / -0"

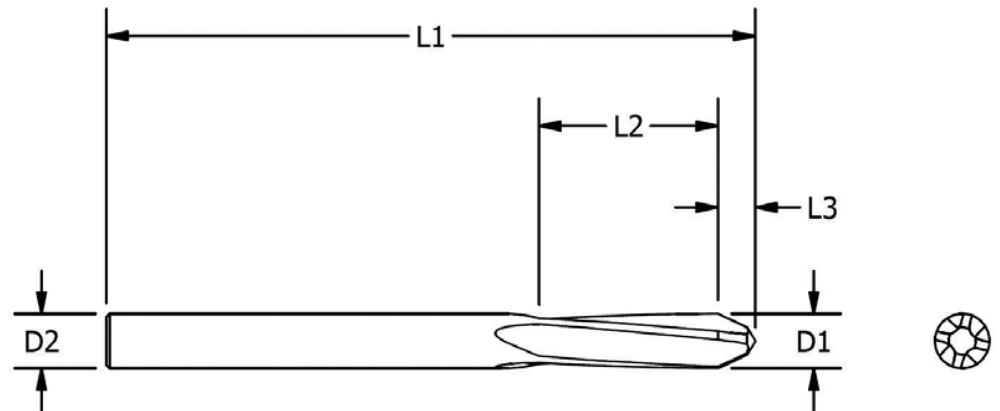

Drill Diameter (D1)		Overall Length	Flute Length	Taper Length	Shank Diameter	Diamond Coating	Part ID
mm	inch	L1	L2	L3	D2	Y/N	
2.489	0.0980	3	1.00	0.067	0.0980	N	B101-10911
3.175	0.1250	3	1.00	0.068	0.1250	N	B101-10912
3.264	0.1285	3	1.00	0.088	0.1285	N	B101-10769
4.102	0.1615	3	1.25	0.111	0.1615	N	B101-11029
4.166	0.1640	3	1.25	0.113	0.1640	N	B101-10913
4.763	0.1875	3	1.25	0.129	0.1875	N	B101-10914
4.826	0.1900	3	1.25	0.130	0.1900	N	B101-11030
4.851	0.1910	3	1.25	0.131	0.1910	N	B101-10915
4.915	0.1935	3	1.25	0.131	0.1935	N	B101-13664
6.350	0.2500	3	1.25	0.172	0.2500	N	B101-10916
6.375	0.2510	3	1.25	0.172	0.2510	N	B101-10917
7.938	0.3125	4	1.50	0.214	0.3125	N	B101-10918
7.950	0.3130	4	1.50	0.215	0.3130	N	B101-11031
9.525	0.3750	4	1.50	0.257	0.3750	N	B101-10919
11.113	0.4375	4	1.50	0.300	0.4375	N	B101-11032
12.700	0.5000	4	1.50	0.343	0.5000	N	B101-11033

COMPOSITE DRILLING

B801 Series - Helical Composite Drill Reamer Short Taper w/ Common Shank uncoated

APPLICATION

CNC, Robotic, and Hand drilling carbon fiber (CFRP)

TOOL GEOMETRY

4 flutes, reduced helix, reduced taper, RH cut, 12 facet point

TOOL MATERIAL

Solid carbide

OD TOLERANCE

D1: $+0.0002'' / -0.0''$

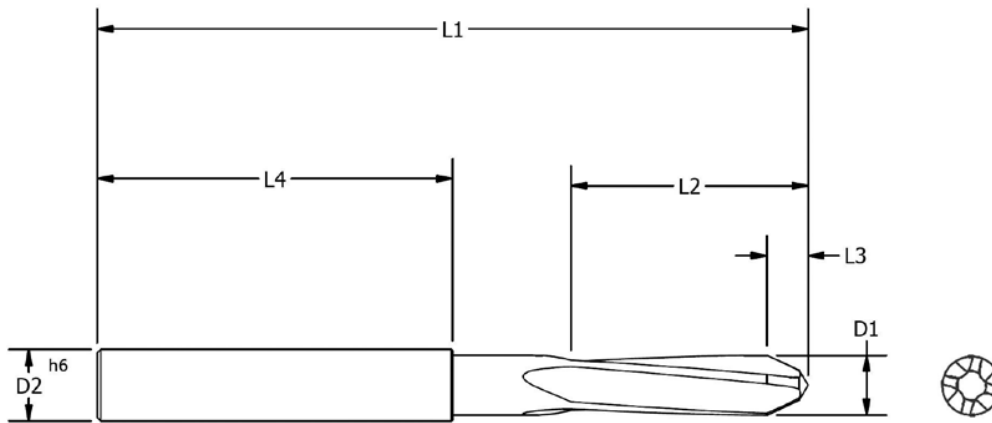

Drill Diameter (D1)		Overall Length	Flute Length	Taper Length	Shank Diameter	Diamond Coating	Part ID
mm	inch	L1	L2	L3	D2 (h6)	Y/N	
2.489	0.0980	3	1.00	0.178	0.2500	N	B801-13479
3.175	0.1250	3	1.00	0.228	0.2500	N	B801-13481
3.264	0.1285	3	1.00	0.234	0.2500	N	B801-13483
4.102	0.1615	3	1.25	0.294	0.2500	N	B801-13485
4.166	0.1640	3	1.25	0.298	0.2500	N	B801-13487
4.763	0.1875	3	1.25	0.341	0.2500	N	B801-13489
4.826	0.1900	3	1.25	0.346	0.2500	N	B801-13491
4.839	0.1905	3	1.25	0.347	0.2500	N	B801-13493
4.851	0.1910	3	1.25	0.348	0.2500	N	B801-13495
4.864	0.1915	3	1.25	0.349	0.2500	N	B801-13497
4.877	0.1920	3	1.25	0.349	0.2500	N	B801-13499
6.363	0.2505	3	1.25	0.456	0.2500	N	B801-13501
6.375	0.2510	3	1.25	0.457	0.2500	N	B801-13503
6.388	0.2515	3	1.25	0.458	0.2500	N	B801-13505
6.401	0.2520	3	1.25	0.459	0.2500	N	B801-13507
7.938	0.3125	4	1.50	0.569	0.3750	N	B801-13509
7.950	0.3130	4	1.50	0.570	0.3750	N	B801-13511
9.525	0.3750	4	1.50	0.683	0.3750	N	B801-13588
11.113	0.4375	4	1.50	0.796	0.5000	N	B801-13513

*Custom geometries available upon request.



B105 Series - Single Flute Composite and Kevlar Drill

APPLICATION

CNC, Robotic, and Hand drilling composite and Kevlar

TOOL GEOMETRY

Single flute, point geometry designed to reduce axial force

TOOL MATERIAL

Solid carbide

OD TOLERANCE

D1: +0" / -0.0005"

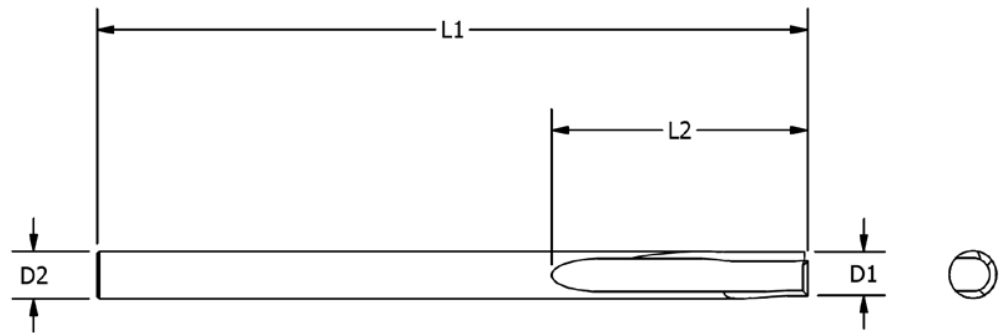

Drill Diameter (D1)		Overall Length	Flute Length	Shank Diameter	Diamond Coating	Part ID
mm	inch	L1	L2	D2	Y/N	
3.175	0.1250	3.00	1.000	0.1250	N	B105-10976
3.264	0.1285	3.00	1.000	0.1285	N	B105-10977
3.967	0.1562	3.00	1.000	0.1562	N	B105-10978
4.763	0.1875	3.00	1.375	0.1875	N	B105-10979
4.915	0.1935	3.00	1.375	0.1935	N	B105-13656
5.558	0.2188	3.00	1.375	0.2188	N	B105-10980
6.350	0.2500	4.00	1.375	0.2500	N	B105-07089
7.142	0.2812	4.00	1.375	0.2812	N	B105-10981
7.938	0.3125	4.00	1.375	0.3125	N	B105-07260
8.733	0.3438	4.00	1.375	0.3438	N	B105-10982
9.525	0.3750	4.00	1.375	0.3750	N	B105-08096

COMPOSITE DRILLING

B122 Series - 90° Point Three Flute Composite Drill diamond coated

APPLICATION

CNC, Robotic, and Hand drilling
carbon fiber (CFRP)

TOOL GEOMETRY

Three flute, RH Helix, 90° point

TOOL MATERIAL

Solid carbide CVD diamond
coated

OD TOLERANCE

D1: +.0004" / -.0002"

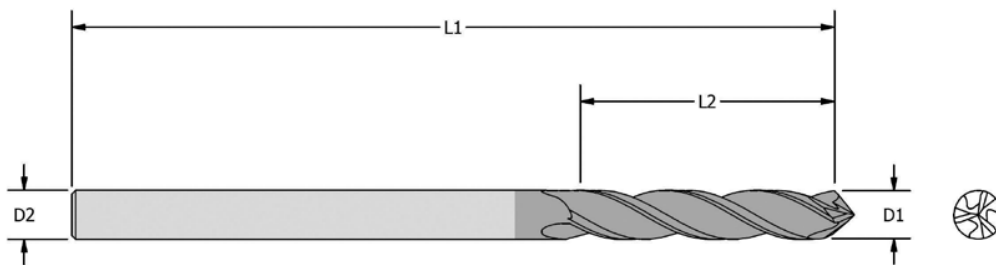

Drill Diameter (D1)		Overall Length	Flute Length	Shank Diameter	Diamond Coating	Part ID
mm	inch	L1	L2	D2	Y/N	
2.489	0.0980	3	1.50	0.0980	Y	B122-13781
3.175	0.1250	3	1.50	0.1250	Y	B122-13782
3.264	0.1285	3	1.50	0.1285	Y	B122-13783
4.089	0.1610	3	1.50	0.1610	Y	B122-13784
4.763	0.1875	3	1.50	0.1875	Y	B122-13785
4.851	0.1910	4	1.50	0.1910	Y	B122-13786
5.613	0.2210	4	2.00	0.2210	Y	B122-13787
6.350	0.2500	4	2.00	0.2500	Y	B122-13788
7.938	0.3125	4	2.00	0.3125	Y	B122-13789
9.525	0.3750	4	2.00	0.3750	Y	B122-13790
11.113	0.4375	6	2.00	0.4375	Y	B122-13791
12.700	0.5000	6	3.00	0.5000	Y	B122-13792

*Custom geometries available upon request.

B106 Series - 90° Point Two Flute Composite Drill diamond coated

APPLICATION

CNC, Robotic, and Hand drilling
carbon fiber (CFRP)

TOOL GEOMETRY

2 flute, RH Helix, 90° point

TOOL MATERIAL

Solid carbide CVD diamond
coated

OD TOLERANCE

D1: +.0004" / - .0002"

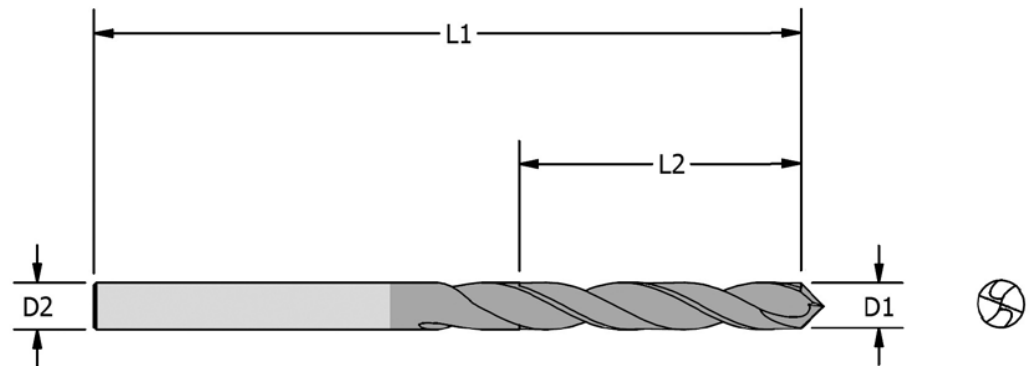

Drill Diameter (D1)		Overall Length	Flute Length	Shank Diameter	Diamond Coating	Part ID
mm	inch	L1	L2	D2	Y/N	
2.489	0.0980	3	1.50	0.0980	Y	B106-11557
3.175	0.1250	3	1.50	0.1250	Y	B106-11558
3.264	0.1285	3	1.50	0.1285	Y	B106-11559
4.089	0.1610	3	1.50	0.1610	Y	B106-11560
4.763	0.1875	3	1.50	0.1875	Y	B106-11561
4.851	0.1910	4	1.50	0.1910	Y	B106-11562
4.915	0.1935	4	1.50	0.1935	Y	B106-13659
5.613	0.2210	4	2.00	0.2210	Y	B106-11563
6.350	0.2500	4	2.00	0.2500	Y	B106-11564
7.938	0.3125	4	2.00	0.3125	Y	B106-11565
9.525	0.3750	4	2.00	0.3750	Y	B106-11566
11.113	0.4375	6	2.00	0.4375	Y	B106-11567
12.700	0.5000	6	3.00	0.5000	Y	B106-11568

COMPOSITE DRILLING

B107 Series - 8 Facet Point Composite Drill

APPLICATION

CNC, Robotic, and Hand drilling
carbon fiber composite (CFRP)

TOOL GEOMETRY

2 flute, RH Helix, 8 facet point

TOOL MATERIAL

Solid carbide (Diamond coating
available upon request)

OD TOLERANCE

D1: +0" / - .0005"

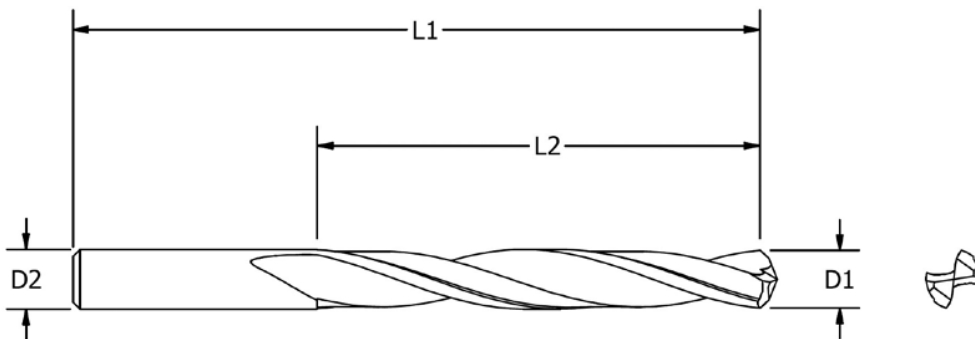

Drill Diameter (D1)		Overall Length	Flute Length	Shank Diameter	Diamond Coating	Part ID
mm	inch	L1	L2	D2	Y/N	
2.489	0.0980	3	1.50	0.0980	N	B107-11917
3.175	0.1250	3	1.50	0.1250	N	B107-11918
3.264	0.1285	3	1.50	0.1285	N	B107-11919
4.089	0.1610	3	1.50	0.1610	N	B107-11920
4.763	0.1875	3	1.50	0.1875	N	B107-11921
4.851	0.1910	4	1.50	0.1910	N	B107-11922
4.915	0.1935	4	1.50	0.1935	N	B107-13658
5.613	0.2210	4	2.00	0.2210	N	B107-02186
6.350	0.2500	4	2.00	0.2500	N	B107-11923
7.938	0.3125	4	2.00	0.3125	N	B107-11924
9.525	0.3750	4	2.00	0.3750	N	B107-11925
11.113	0.4375	6	2.00	0.4375	N	B107-11926
12.700	0.5000	6	3.00	0.5000	N	B107-11927

*Custom geometries and coatings available upon request.



B108 Series - W Point Drill for Kevlar and Composite

APPLICATION

CNC, Robotic, and Hand drilling Kevlar and carbon fiber composite (CFRP)

TOOL GEOMETRY

2 flute, W point, RH Helix

TOOL MATERIAL

Solid carbide (Diamond coating available upon request)

OD TOLERANCE

D1: +0" / -0.0005"

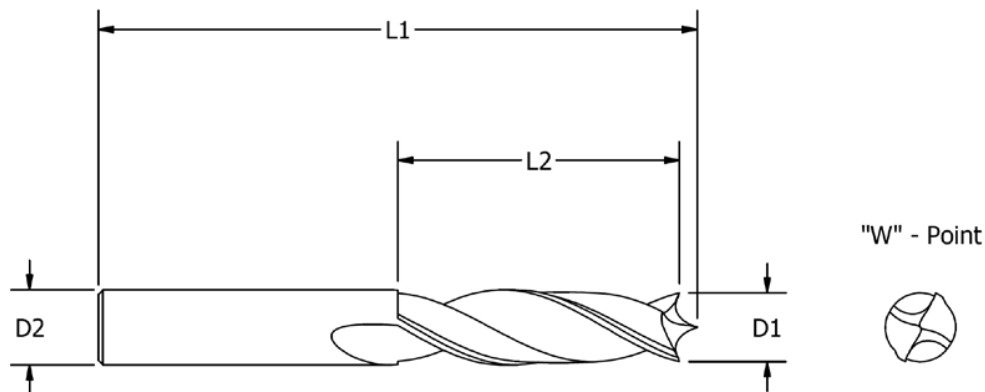

Drill Diameter (D1)		Overall Length	Flute Length	Shank Diameter	Diamond Coating	Part ID
mm	inch	L1	L2	D2	Y/N	
2.489	0.0980	3	1.50	0.0980	N	B108-12209
3.175	0.1250	3	1.50	0.1250	N	B108-12210
3.264	0.1285	3	1.50	0.1285	N	B108-12211
4.089	0.1610	3	1.50	0.1610	N	B108-12212
4.763	0.1875	3	1.50	0.1875	N	B108-12213
4.851	0.1910	4	1.50	0.1910	N	B108-12214
4.915	0.1935	4	1.50	0.1935	N	B108-13657
5.613	0.2210	4	2.00	0.2210	N	B108-12215
6.350	0.2500	4	2.00	0.2500	N	B108-12216
7.938	0.3125	4	2.00	0.3125	N	B108-12217
9.525	0.3750	4	2.00	0.3750	N	B108-12218
11.113	0.4375	6	2.00	0.4375	N	B108-12219
12.700	0.5000	6	3.00	0.5000	N	B108-12220